

**AUTO-INDEX  
RELIEFING SYSTEM!**

**neary**  
TECHNOLOGIES



**555 SRI**



The door and cabinet enclosure is a safety feature the entire shop can appreciate, as dust and noise is limited during the grind process.



Multi-position brackets for supporting the reel by the frame, and "V" brackets for supporting the front roller during setup make reel placement easy and repetitious.

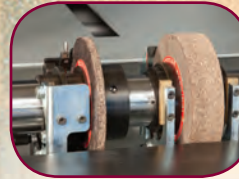

Patented Auto-Index Relief Grinding System allows for both automatic spin and relief grinding with one easy setup. The hands-free operation during the relief grind allows the operator to perform other tasks while the machine does the work.



Digital gauge for fast and accurate horizontal alignment allows for easy measurements and removal of reel taper.



Dual in-feed handwheels allows for quick touch-off alignment, and the digital scales provide easy reading for taper removal.



Control console is conveniently located in front where the operator has easy access to variable speed spin and traverse controls. This enables a safe transition from the spin to relief process.

### Specifications

- Overall..... 77" long x 49" wide x 70" high
- Shipping..... 86" long x 62" wide x 77" high, 237 cubic feet
- Weight..... 1450 lbs.
- Power..... 115 volts, 60/50 hertz, single phase, 20 amp circuit
- Grinding Wheel..... Spin: 6" OD x 2.75" ID x 1.5" thick 46 grit type 1  
Relief: 6" OD x 2.75" ID x .375" thick 24 grit type 1
- Grinding Motors..... 1 HP 3450/2875 RPM

### Standard Features

- Frame Design ..... Integrally engineered & welded, safety guarding standard
- Controls ..... Automatic travel, variable length, variable speed, manual infeed, dual handle wheels, digital scales, automatic spin grinding, variable relief torque
- Grinding Shaft ..... Engineered alloy precision ground 2.375 diameter
- Set Up..... Multi-position brackets for support by frame of cutting unit, "V" brackets for support by front roller Rear Roller Quick Clamp®
- Diamond Dresser ..... Rapid mount quick adjust
- Tools ..... Operators manual, diamond dresser, multi-position brackets, front roller brackets, alignment gauge bracket
- Alignment..... Digital horizontal alignment gauge and taper checker

### Optional Equipment

- The Workstation ..... Is not only used to transfer cutting units into the reel grinder, it can also be used as a mobile workbench
- Loading Boom..... Can be either manual or electric lift
- Transformer..... 220V to 110V step down transformer

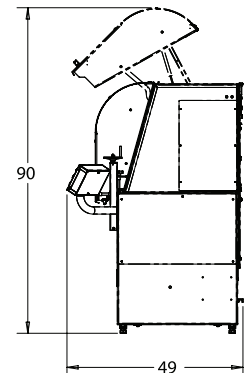
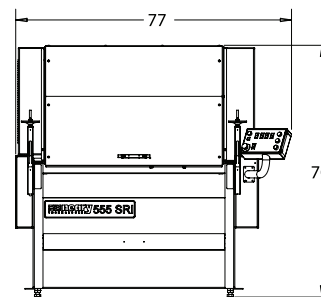

Neary continually changes and improves its products based on the needs of the customer, Neary reserves the right to change specifications without notice.